

# AMAZING GRACE MAKEOVER

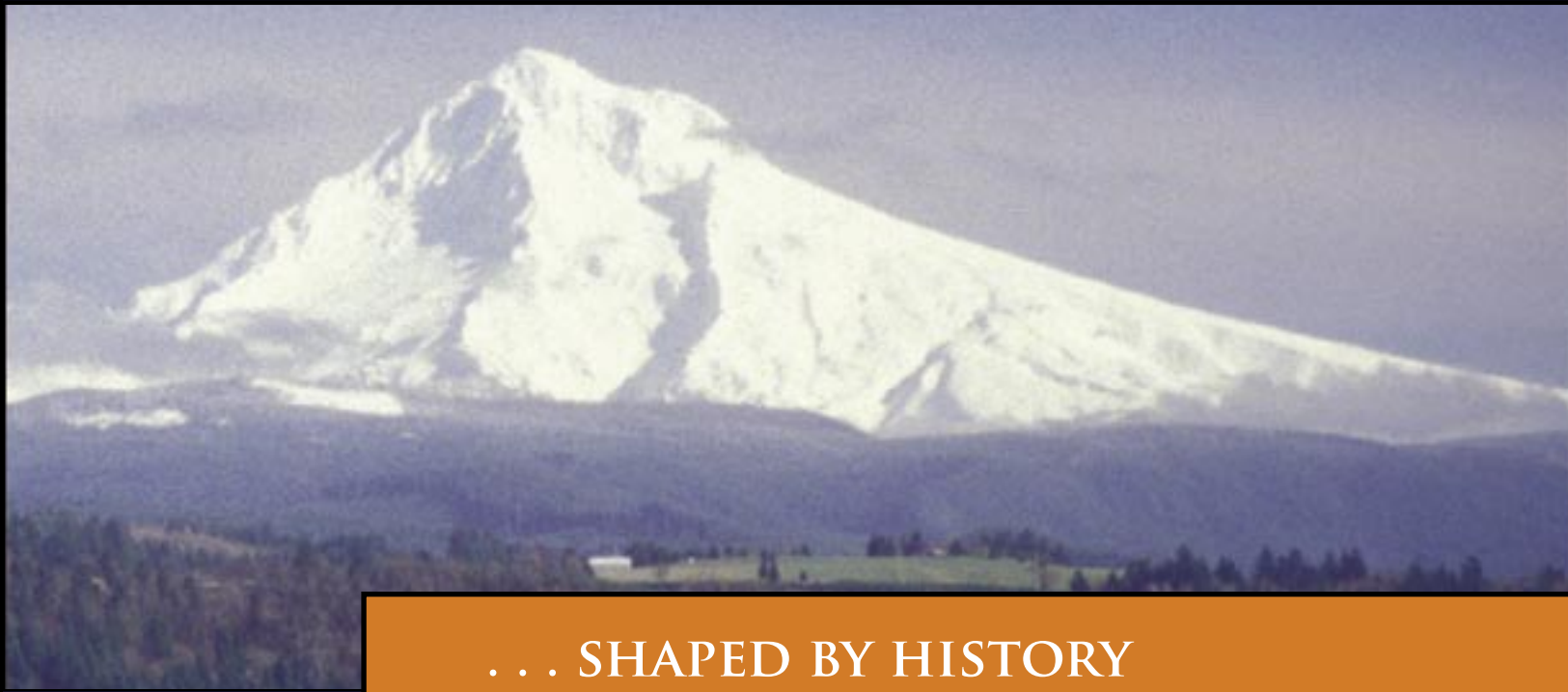

... SHAPED BY HISTORY  
... LED BY VISION  
... COMPLETED BY FAITH!

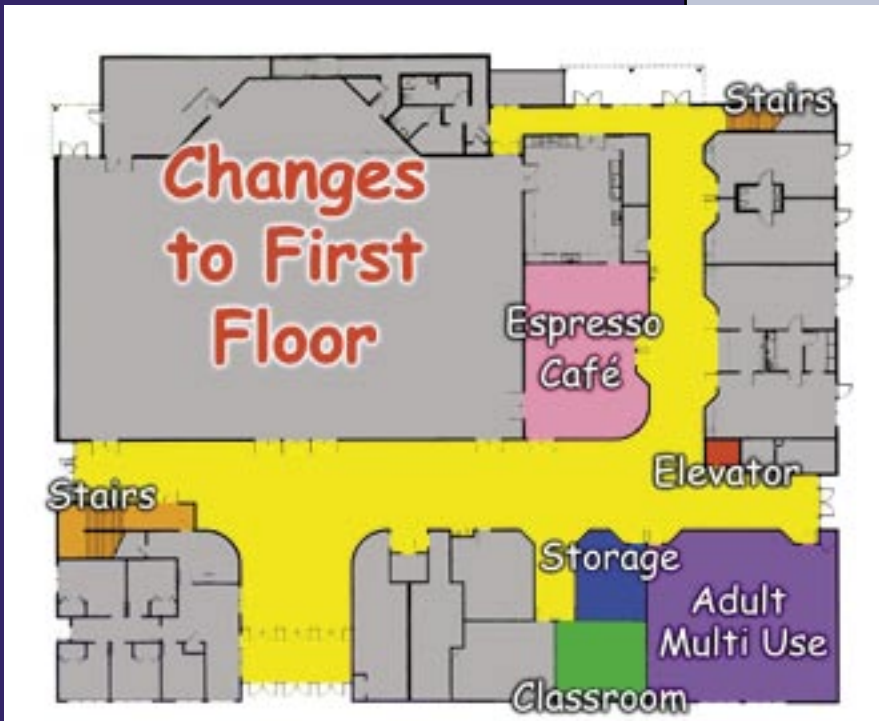



## MAIN LEVEL

Reallocation of 3000 sq ft (currently used for children and students) to much-needed adult ministry space

Reception Room transforms to a new Espresso Cafe with cozy furnishings, gas fireplace and big-screen TV

Complete makeover of the entire front of the building, creating a fresh, inviting appearance

New covered entryway extending from the front door to the parking lot

Current children's classroom converted to storage.

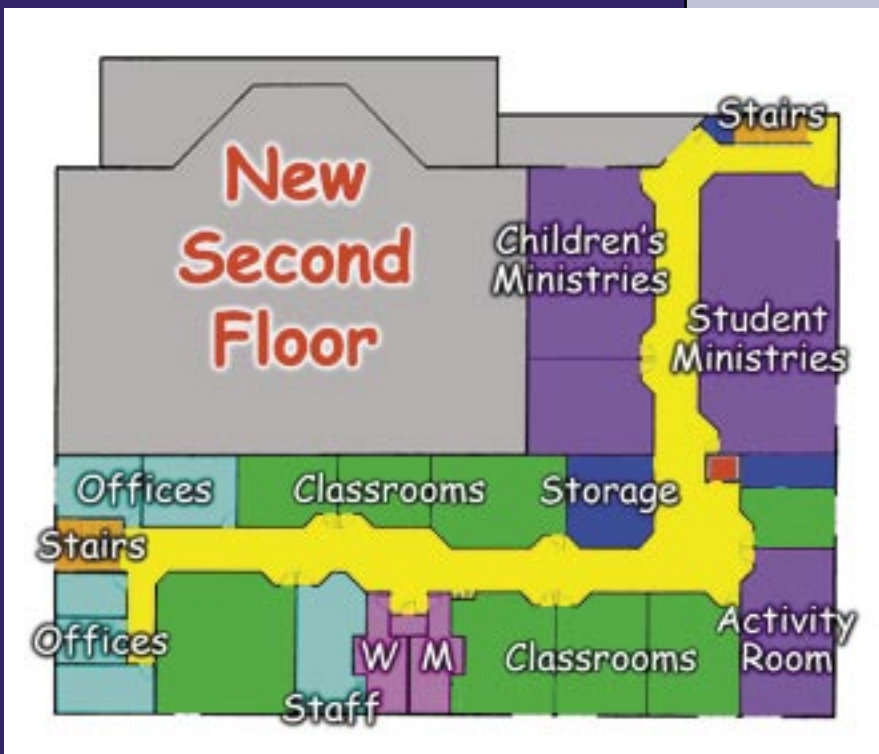

## SECOND FLOOR

15,000 sq ft of new ministry area

Five new offices (four for staff, one for lay leaders and volunteers)

New Student Ministries Room (25% larger than current space)

New Children's Ministries Center

Combined Children's/Student Activity Center

Eight multi-age classrooms

Elevator

Additional restrooms

# AMAZING GRACE MAKEOVER

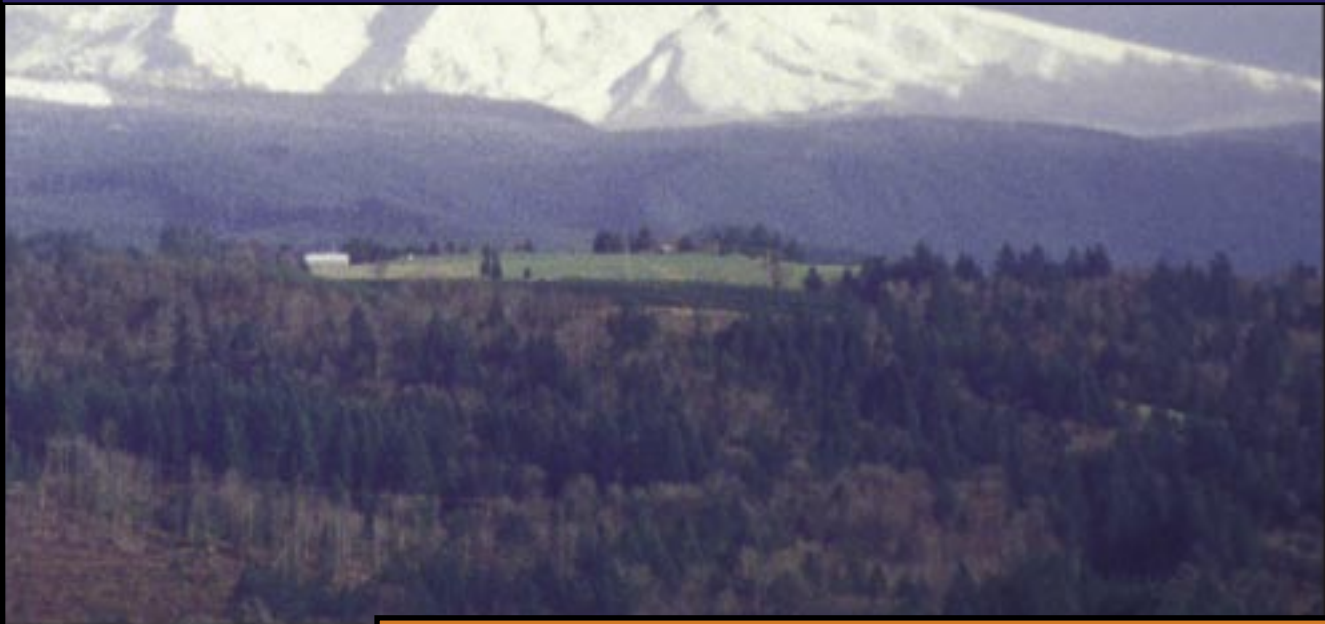

... SHAPED BY HISTORY  
... LED BY VISION  
... COMPLETED BY FAITH!



Dear friends,

## GOD CAN TAKE THE ORDINARY AND MAKE IT **EXTRAORDINARY.**

Do you believe that? Do you *really* believe that?

Over the past several months, the book of Acts has shown us life after life miraculously changed by God. We've seen Him growing His church, advancing His Kingdom and using ordinary people to accomplish amazing things. The early church was a community of people devoted to loving one another and loving lost people. These bold believers were willing to step out, take risks and follow God wherever He led.

**Would you like to be part of a church like that?** Do you want to be part of something larger than yourself? Something beyond your apparent capacity and resources, that will involve risk, trust and faith? Are you willing to leave the safety of what's familiar in order to partner with God in something only He can do?

*If you're like me, you probably find yourself hesitating and asking, Am I willing? Honestly willing?*

What if the end result was a deeper intimacy with God, a tangible change in your character, a profound sense of unity with your church family, and an unmistakable impact on your community? Now would you want to risk taking part? And what would you call an endeavor like that? How about the

## “AMAZING GRACE MAKEOVER”?

**We, as Grace Community Church, have a vision for lives and for our community.** Our elders and staff believe the next step toward achieving Grace's vision is a step of faith, taking advantage of the temporary changes in building codes and completing the second floor of our facility. The additional classrooms, meeting and office space will provide vital tools for the fulfillment of our mission to change lives and to bring honor to our God.

The *Amazing Grace Makeover* isn't about paint and drywall, but about seeking God's guidance as we obediently and creatively steward the resources He's entrusted to us. It's about following Him to accomplish a God-sized



undertaking. The risk is real, the rewards are great, and the results will be visibly realized in lives transformed by Christ.

It's time for our *Amazing Grace Makeover*. And it starts . . . with you and me.

Following an Extraordinary God with you,

Pastor Jay

## The Commitment

The goal before us is substantial - to raise \$1,250,000 in cash, gifts of assets, and three-year commitments by Sunday, June 4, 2006 (Celebration and Commitment Sunday). After much prayer, our elders have determined that the Grace family must support The *Amazing Grace Makeover* campaign with gifts and pledges of at least \$600,000 or more of "new money" not including funds raised prior to May 7, 2006. Our elders and finance team will then begin evaluating options for financing the amount needed to build the second floor. We want this space available for ministry as soon as possible.

If we borrow, then our monthly church budget will increase by the amount necessary to pay the loan installments.

However, even though borrowing is an option we are willing to consider, with much prayer and with God's enabling, we are still setting our sights on the goal to give the full \$1,250,000, so we can avoid additional debt. The project will not go forward unless at least \$600,000 is given. \$1,250,000 is the estimated cost of construction. Fluctuating labor and material costs will likely affect the final, total cost of construction.

### Sample commitments you can make over a 3 year period. (Over and Above Regular Giving)

Weekly	Monthly	Annually	3 Year Total
\$500	\$2,167	\$26,000	\$78,000
\$400	\$1,733	\$20,800	\$62,400
\$350	\$1,517	\$18,200	\$54,600
\$300	\$1,300	\$15,600	\$46,800
\$250	\$1,083	\$13,000	\$39,000
\$200	\$867	\$10,400	\$31,200
\$175	\$758	\$9,100	\$27,300
\$150	\$650	\$7,800	\$23,400
\$125	\$542	\$6,500	\$19,500
\$100	\$433	\$5,200	\$15,600
\$75	\$325	\$3,900	\$11,700
\$50	\$217	\$2,600	\$7,800
\$35	\$152	\$1,820	\$5,460
\$25	\$108	\$1,300	\$3,900
\$15	\$65	\$780	\$2,340
\$10	\$43	\$520	\$1,560

## Call to Prayer from Our Elders

(Excerpted from the congregational letter of February 2006)

Above all else, we, as your elder team, are calling you as a church family to a continued season of focused prayer. Our desire is to be led by the Lord in all we do, seeking and following Him in obedience, humility and living through the power of the Holy Spirit. Please pray for our corporate purity, wisdom, and protection from the evil one as we strive to fulfill our part in changing lives for Christ and fulfilling His Commission to us.

God has truly blessed our church with a compelling and focused vision, a heart of unity, and a willingness to grow and follow Him. Let's continue forward, together, into the future He has prepared for us. We have great things ahead of us!

Now it is time to pray individually and as families during the weeks ahead:

*Father, what do you want to do through me to fulfill Your purpose at Grace?*

# Completed by *Faith!*

The *Amazing Grace Makeover* campaign sets for us the goal of raising \$1,250,000 over and above regular giving. The *Makeover* is an extraordinary faith venture to discover God's financial provision for this vision. Each family and individual who calls Grace home is now entrusted with the privilege of cheerful, worshipful giving.

*“Not equal giving, but equal sacrifice.”*

This vision can only be realized if the whole church embraces it and personally commits to it. Each of us, regardless of our financial situation, is challenged to pray fervently and to make a commitment toward the three-year campaign that can only be fulfilled by faithful stewardship and sacrificial giving.

*Let us be compelled to depend on God and then stand amazed at what He accomplishes.*

How will you respond to God's call?

*“I want each of you to take plenty of time to think it over, and make up your mind what you will give... God loves it when the giver delights in the giving. God can pour on the blessings in astonishing ways so that you're ready for anything and everything, more than just ready to do what needs to be done.” 2 Corinthians 9:7-8 (Message)*

Significant contributions will come from gifts of stocks, bonds, real estate... even vehicles. Important tax benefits are available when you give appreciated assets.



*f* FAITH

# THE AMAZING GRACE MAKEOVER . . .

## *Why a makeover?*

- To provide vitally needed classroom and office space for the realization of our vision
- To take advantage of temporary changes in the building codes that make this expansion financially feasible; we lose this opportunity if we don't obtain permits in 2006
- To fulfill our original 1997 vision for a two-story campus design
- To unlock new teaching opportunities and better utilize the many teaching resources at Grace
- To maximize the discipleship and equipping of our children, students and adults, obeying our mandate to present everyone complete in Christ and to reach out to our world
- To more effectively train up current and future leaders
- To allow our staff to dream toward more options for adult education and programming
- To alleviate overcrowding on Sunday mornings
- To simplify family schedules at Grace by consolidating some ministries on the same night
- To transform existing space so as to create a warmer environment for guests
- To catch up with *current* growth and prepare for inevitable *future* growth in our community and church
- To help and bless other churches and ministries by providing additional resources
- To provide a place for more community organizations to conduct their activities (the school district, Red Cross blood drives, crisis response training and more)
- To afford more options for our outreach events (such as neighborhood health clinics; (Compassion Rockwood;) marriage, parenting and financial counseling classes; and English as a Second Language)
- To make Grace a "Third Place" (Your primary place of community and connection)
- To grow further in faith as we fulfill God's vision and mission for our church



... shaped by history  
... led by vision  
... completed by faith!

# HISTORY



## Shaped by History

Over the last 25 years, Gresham Hills Baptist Church, Gresham Community Baptist Church and Eastmont Baptist Church merged to become Grace Community Church. Throughout the journeys of the separate and combined congregations, we have inhabited more than a dozen different locations, arriving finally at our current facility.

Our current 7.25 acres were originally Ernie and Violet Ruegger's dairy farm. After Mrs. Ruegger graciously sold us the property at a very reasonable price, we began construction and enjoyed our first Sunday here on December 7, 1997.

While formulating the 1997 Grow with Grace campaign, we envisioned and literally laid the groundwork for future expansion. You now have the opportunity to be an integral part in the fulfillment of that vision.

# Led by Vision

A fresh wind is blowing in East County. The Holy Spirit is transforming us as a people. The divine Potter is using our vision to shape and mold Grace Community Church to become a

## Vibrant, Growing, Intentional, Equipping

community of believers. We're discovering a new attitude of optimism in response to the vision developed by our entire church family with our elders' leadership. This vision charts a path for us today and sets a course for generations of future leaders. The new physical space will provide for spiritual enrichment and lifelong relationships as we worship and celebrate together.

*The Amazing Grace Makeover* is building to facilitate the vision.

By faith we will join God in making the ordinary . . . .



*extraordinary*



. . . SHAPED BY HISTORY

. . . LED BY VISION

. . . COMPLETED BY FAITH!

VISION

